

Side Elevation

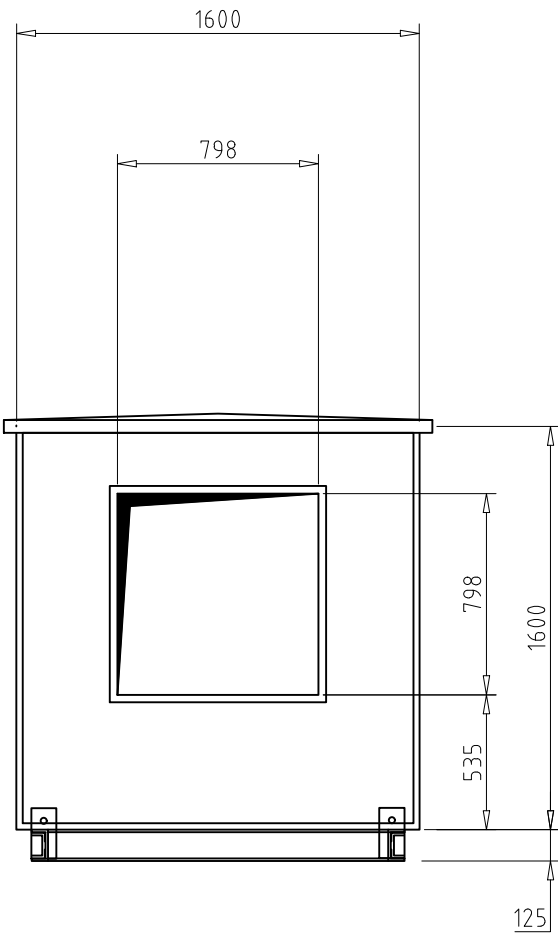

End Elevation - discharge

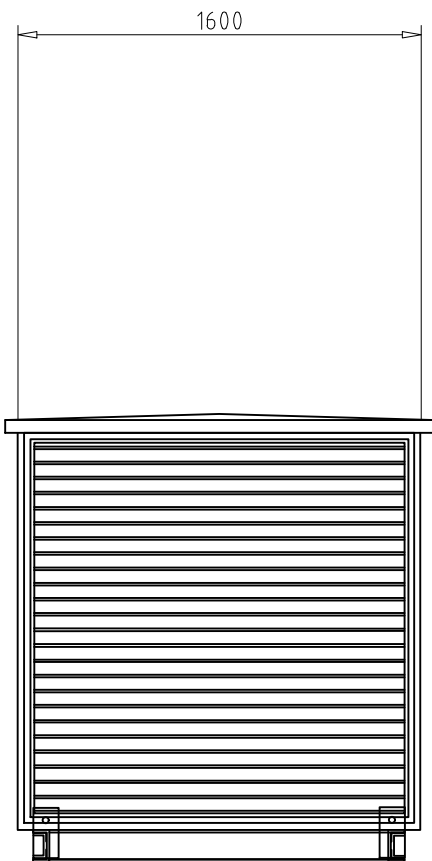

End Elevation - intake

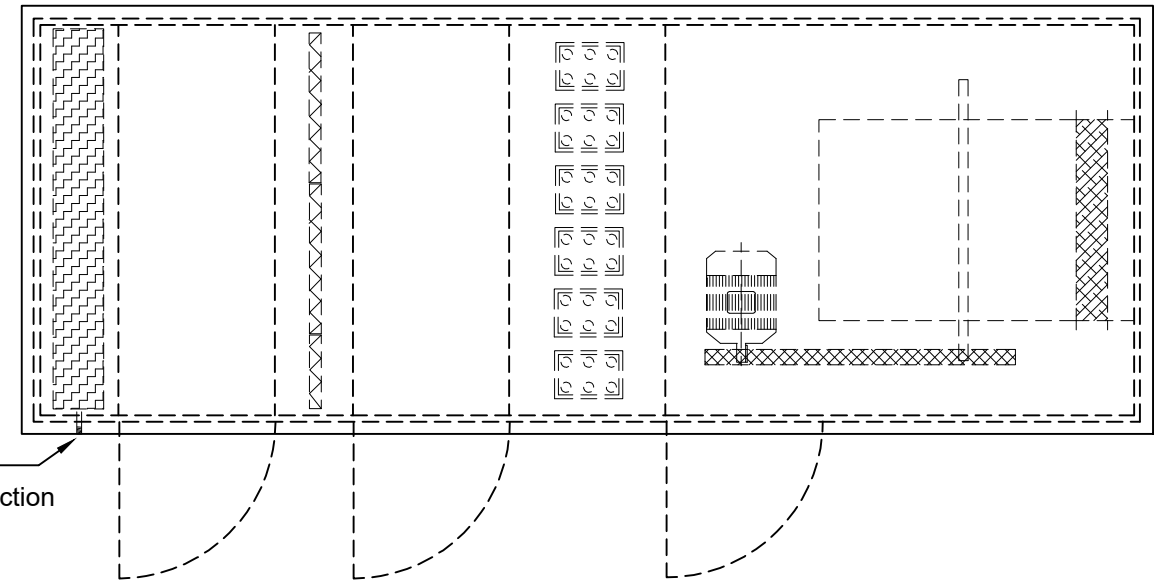

Plan

All access RHS

Notes

Aera/Unit Reference	Waste Marshalling												
Constuction/Finish	304 Panels & Cowl - GAM Unit Base												
Eliminator Section	304 Frame with Plastic Blades												
Filter Type	Washable												
Filter Size (actual)	4 No 594x594x47 - 4 No 594x292x47 - 1 No 292x292x47												
Filter Grade	G4												
Spare Set of Filters	Yes												
No of Ionisers	6												
Ioniser Model	Aerotron 1000												
Supply Air Volum m³/s	4.16												
External Pa	500												
Total Pa	790												
Fan Type	DIDW Backward Curved Aerofoil												
Fan Reference	RZR 11-0630 ErP 2105 Compliant												
Fan Speed	1063												
Absorbed Power kW	4.59												
Specific Fan Power W/l/s	1103												
In Duct Fan Sound Power Level	Hz	63	125	250	500	1k	2k	4k	8k				
Inlet	dB	78	81	78	77	74	72	66	60				
Discharge	dB	81	81	81	78	73	67	63	55				
Fan Pulley	200 x 2 SPZ x 400												
Motor Pulley	140 x 2 SPZ x 380												
Belt Length	2 x SPZ 2500 + 2 Spare												
Motor Type	WP-DA132MVX												
Motor Output kW	7.5												
Motor Speed RPM	1450												
Voltage	400/3/50												
PLC amps	14.6												
SC amps	x 7.6 (DOL)												
AV Type	ES/0-130 & 200												
Access	RHS												
Weight kg	1369 kg												

1.0	First Draft - For Approval	AR	AS	10/08/21
Rev	Note	Dwg	Chk	Date

This drawing and its contents are the property of CSO Group Ltd and must not be copied or disclosed to any third party without the written permission of CSO Group Ltd.

Chequers Barn - Chequers Hill
Bough Beech - Edenbridge
Kent - TN8 7PD
T: +44 (0) 1732 700011
E: sales@csogroup.co.uk
W: www.csogroup.co.uk

Title

Wasteserv Malya
Terminodour & Regenerative Thermal
Oxidation Odour Control System

Terminodour AHU Model 6.25
General Arrangement

Drawn By	Date	Sheet	Scale
AR	09/08/21	1/1	1:30 @ A2
Drawing No.			Revision
G002370-03-02			1.0

